

uFace202

Multi-Biometric T&A and Access Control Terminal



ZKTeco has released the uFace202 Multi-Biometric T&A and Access Control Terminal which supports 3,000 face templates, 4,000 fingerprint templates and 10,000 cards (optional). It is equipped with ZKTeco latest hardware platform and algorithm, which provide clients with a brand new UI and user-friendly operating interface, bringing them a smooth using experience. With the advanced face algorithm and multi-biometric verification technology, the terminal's security level of verification is greatly enhanced.

Features

- 3,000 face and 4,000 fingerprint templates Multi-languages
- High verification speed
- Advanced and user-friendly UI
- Chip encryption for firmware protection
- Optional built-in battery backup providing approximately 4 hours of continuous operation
- Easy to extend functions and customize client's requirements
- One face template is registered for one user only
- Able to detect whether the face is an actual face or a photo, enhancing the security level of verification

Specifications

Display	4.3-Inch Touch Screen
Face capacity	3,000
Fingerprint capacity	4,000
Card capacity	10,000 (optional)
Logs capacity	100,000
Communication	TCP/IP, RS485, USB Host, WiFi(Optional)
Standard Functions	Automatic Status Switch, Self-Service Query, Work Code, SMS, DST, T9 Input, 9 Digit User ID, Scheduled Bell, Photo ID
Interfaces for Access Control	3rd Party Electric Lock, Door Sensor, Exit Button, Alarm
Wiegand Signal	Output
Optional Functions	ID/MiFare Card, Wi-Fi, 3G, ADMS, 2000 mAH Backup Battery
Power Supply	12V 3A
Operating Temperature	0 °C- 45 °C
Operating Humidity	20%-80%
Dimensions	193.7*164.5*112.5mm (Length*Width*Thickness)
Package Weight	1.6 kg

Configuration

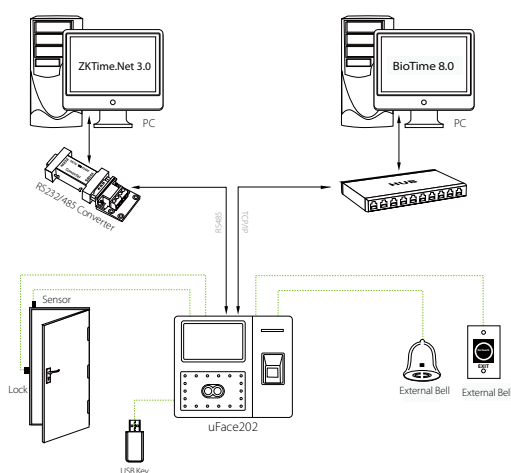

What's in the Box

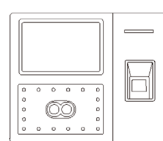

uFace202

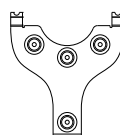

Back Plate

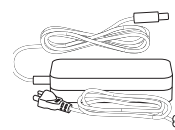

Power Adapter



Lines for Access Control Interface



Mounting Paper



Screws and Holders



Screw Driver



Paper ruler

